

Instruction Manual

Extension Stick Set

Introduction

Thank you for purchase this extension stick set, it can be use with or without optional airflow cone by different clips. The complete extension set includes:

1. Extension stick x 1 pc
2. Phone holder x 1 set
3. Demountable clip x 2 pcs
(Anemometer clip & Airflow cone clip)
4. Soft carry case x 1pc
5. Instruction manual x 1 set



Operation

Anemometer Clip

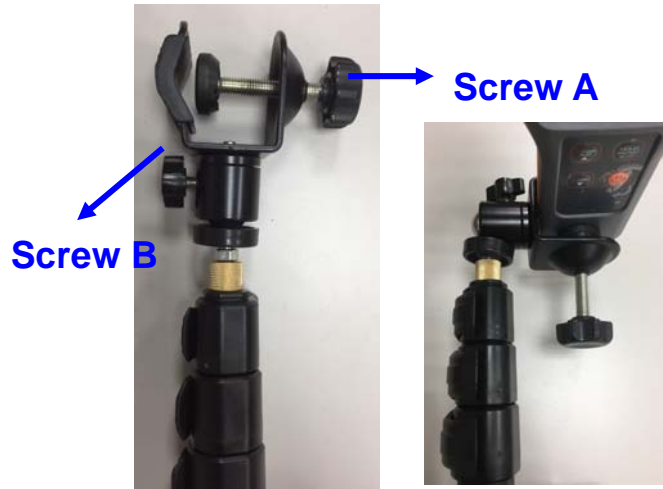

1. Mount the clip on extension stick, rotate the clip in clockwise direction until tight.
2. Loose **screw A** by rotate it in counterclockwise direction
3. Clip on the anemometer, rotate **screw A** in clockwise direction to fix it tight.

Note: Prevent to clip on the vane or keypad area.

4. Loose **screw B** to adjust the tilt angle by rotates it in clockwise way.
5. After adjust it to the designed tilt angle, rotate **screw B** in counterclockwise way to fix it tight

Airflow Cone Clip

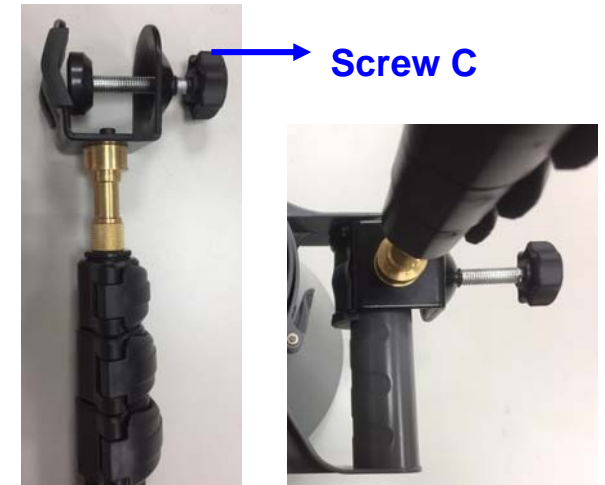

1. Mount the clip on extension stick, rotate the clip in clockwise direction until tight.
2. Loose **screw C** by rotate it in counterclockwise direction
3. Clip on the airflow cone handle, rotate **screw C** in clockwise direction to fix it tight.

Note: Before clip on the airflow cone, make sure the anemometer is well mounted on the airflow cone and locked tight.

Phone holder

